

## NFBIC-4LMRAT

### 4" Recessed LED IC / Non-IC Housing - 2 Hour Fire & Sound Dampening Rated

#### PRODUCT DESCRIPTION

Specification grade fire-rated new construction housing. The double wall fixture incorporates a non-combustible fiber insulation to prevent passage of flames, toxic gases, ignitable gasses into ceiling plenums. The cULus listed housing is rated for a minimum of 2 hours protection. The noncombustible fiber fill also acts as sound deadening material eliminating the transfer of sound between floors. Suitable for commercial, multi-family and residential applications.

#### FEATURES

- Rated for direct contact with insulation
- cULus classified 2 Hour Fire Rating
- cULus Wet Listed (Only with designated trims)
- cULus listed for damp location and through branch circuit wiring
- Quick connect provided
- 24-1/2" Bar hangers with captive nails and alignment foot
- Accommodates 1-3/4" maximum ceiling thickness
- cULus and ENERGY STAR listed for wet locations

#### CONSTRUCTION

**Plaster Frame:** High quality 0.03" steel die cut one piece frame.

**Housing:** Die formed 20 guage galvanized steel construction. Housing interior is comprised of a flexible non-combustible insulation.

**Air Flow Restriction:** Housing has factory installed gaskets to restrict airflow from room into ceiling plenum to <2CFM (cubic feet per minute) in accordance with ASTM-283 Air-Tight requirements.

**Sound Deadening:** STC tested by a certified acoustical testing lab. STC (Sound Transfer Class) was only change by 1 point when NFBIC housing was installed. Test reports on file.

**Socket Connector:** Quick connect provided for electrical connection to LED compatible trim.

**Bar Hangers:** Two 13-3/4" to 24-1/2" adjustable bar hangers with captive nails are included on frame. Bar hangers are parallel to junction box, but can be repositioned 90° perpendicular to junction box if desired. "L" Shaped bar hanger foot to align to bottom of construction joist. A T-Bar notch allow for easy installation in a suspended ceiling.

**Junction Box:** Prewired 0.03" thick galvanized steel, with seven 1/2" knockouts, four Romex® pryouts, and snap on covers. All leads are #18AWG wire, the ground wire is connected to the bottom, and quick connectors are supplied on all leads. Through branch circuit wiring, (4-in, 4-out).

**Quick Connect Feature:** Housing contains three UL approved quick connections that allow insertion of 1/4" stripped solid or tinned standard conductors to be inserted into the connector. Connectors are pre-attached to fixture power, common, and ground circuits.

**Thermal Protector:** Standard UL thermal protector rated for 90°C is affixed to inner top surface of housing.

**Installation:** Number of luminaires not to exceed the ratio, one per 25sq ft of the total ceiling area, with minimum separation of 3ft between luminaires.

#### LABELS AND LISTINGS

- cULus Classified for two hour fire rating
- cULus Listed for Damp Locations with feed through
- cULus Listed for Wet Locations when used with compatible trims
- Meets or exceeds ASTM-283 Air-Tight requirements
- ANSI/UL 263
- ANSI/UL 1598
- STC tested for sound transfer



#### PRODUCT IMAGES AND DIMENSIONS

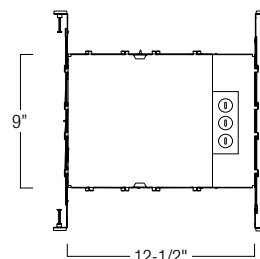
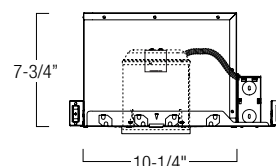

#### 4" Recessed LED Firebox

Housing

NFBIC-4LMRAT = 4" Dedicated LED - 2 Hour Fire Rated Housing

#### Compatible Trims

Cobalt Series

- NLCBC-453 = 4" Cobalt Series, Squared Round
- NLCBC-455 = 4" Cobalt Series, Squared Pinhole
- NLCBC-456 = 4" Cobalt Series, Squared Regress
- NLCBC-451D = 4" Cobalt Series, Deep Reflector
- NLCBC-452D = 4" Cobalt Series, Deep Baffle

Onyx Series

- NOX-431 = 4" Onyx Series, Reflector
- NOX-432 = 4" Onyx Series, Baffle

Iolite Series

- NIR-4RG = 4" Iolite Series, Round, Surface Regress
- NIR-4RC = 4" Iolite Series, Round, Cone Regress
- NIR-4SG = 4" Iolite Series, Square, Surface Regress
- NIR-4SC = 4" Iolite Series, Square, Cone Regress

Example: NFBIC-4LMRAT = 4" Dedicated LED - 2 Hour Fire Rated Housing