

Pex™ 4" Round Adjustable Gimbal

Pex™ Precision die-cast adjustable trims with twist-&-lock system for easy Koto™ Module installation



Features

- 4" Round Gimbal.
- 35° tilt. 358° rotation.
- Convenient twist-lock design for easy installation.
- Lamp: Koto™ LED Module.

Technical Details

Construction: Diecast aluminum with a powder coated finish.

Installation: Twist-lock design allows for easy mounting onto the Koto™ LED Module.

Compatible Housing: Compatible with 4" housings.

With ELK07 & ELK09 Module:

- EL485ICA, EL490ICA, ELK490ICA-EM5, EL490RICA & EL49FICA

With ELK19 & ELK21 Module:

- E4LK98ICA, E4LK99ICAD, E4LK87ICA, E4LK87ICA-EM1, E4LK88ICAD, E4LK88ICAD-EM1, E4LK87RICA, E4LK88RICAD, ELK49FICA & ELK49FICAD

Lamp: Koto™ LED Module.

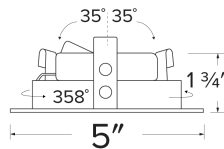
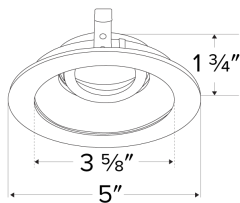

Dimensions:

Options



All White



All Black



All Bronze



Black with White Ring



Chrome with White Ring



Haze with White Ring

Product Numbers

Item	Finish
ELK4129W	All White
ELK4129BB	All Black
ELK4129BZ	All Bronze
ELK4129B	Black with White Ring
ELK4129C	Chrome with White Ring
ELK4129H	Haze with White Ring

Product Number Builder Example: ELK4129W

Pex™ 4" Round Gimbal	Finish
ELK4129	

- W** All White
- BB** All Black
- BZ** All Bronze
- B** Black with White Ring
- C** Chrome with White Ring
- H** Haze with White Ring

Compatible Products



For use with Koto™ System 4" Trims

Koto™ LED Module



ELK07, ELK09
Koto™ LED Module

PRODUCT NUMBER BUILDER

Koto™ LED Module	Lumens	Color Temperature	Beam Angle
ELK			
	07 750 lm	27 2700K	(blank) 38° lens (Standard)
	09 950 lm	30 3000K	-S 18° lens
		35 3500K	-N 25° lens
		40 4000K	-W 60° lens
		SD Sunset Dimming	

ACCESSORIES



Lens

- EP731C** 18° Lens
- EP732C** 25° Lens
- EP734C** 60° Lens



Reflectors

- EP735C** 15°
- EP736C** 25°
- EP737C** 38°
- EP738C** 60°



Hex Louver
L45

For a better glare shield



Linear Louver
L46

For a wide rectangular illumination pattern



Spread Louver
L47

For a symmetrical broadening of light beams



Clear Lens
L48

Protective clear glass lens

4" Koto™ Dedicated LED ICA Housing



2-Hour Fire Rated
4" ICA Housing - 7 1/2" Height
New Construction

CAT NO.	SPECIFICATIONS
EL49FICA	



4" ICA Maximum Adjustability
Housing - 5 1/2" Height
New Construction

CAT NO.	SPECIFICATIONS
EL485ICA	Maximum Adjustability



4" ICA Housing - 5 1/2" Height
New Construction

CAT NO.	SPECIFICATIONS
EL490ICA	
EL490ICA-EM5	Emergency Battery Back-up (90 minutes)



4" ICA Housing - 5 1/2" Height
Remodel

CAT NO.	SPECIFICATIONS
EL490RICA	

Compatible Products



For use with Koto™ System 4" Trims

Koto™ Commercial Construction LED Light Engine



ELK19 ELK21
Koto™ LED Light Engine

PRODUCT NUMBER BUILDER

Koto™ LED Light Engine	Lumens	Color Temperature	Beam Angle
ELK	19 850 lm 21 1100 lm	27D 2700K 30D 3000K 35D 3500K 40D 4000K SDD Sunset Dimming	(blank) 38° lens (Standard) -S 18° lens -N 25° lens -W 60° lens

ACCESSORIES



Lens

EP731C 18° Lens
EP732C 25° Lens
EP734C 60° Lens



Reflectors

EP735C 15°
EP736C 25°
EP737C 38°
EP738C 60°



Hex Louver
L45

For a better glare shield



Linear Louver
L46

For a wide rectangular illumination pattern



Spread Louver
L47

For a symmetrical broadening of light beams



Clear Lens
L48

Protective clear glass lens

4" Commercial Construction Koto™ Dedicated LED ICA Housings



2-Hour Fire Rated
4" ICA Housing - 7 1/2" Height
New Construction



4" ICA Shallow Adjustability Housing - 4" Height
New Construction



4" ICA Housing - 5 1/2" Height
New Construction

CAT NO.	SPECIFICATIONS
ELK49FICA	120V - Triac/ELV
ELK49FICAD	120/277V - 0-10V/Triac/ELV

CAT NO.	SPECIFICATIONS
E4LK98ICA	120V - Triac/ELV
E4LK99ICAD	120/277V - 0-10V/Triac/ELV

CAT NO.	SPECIFICATIONS
E4LK87ICA	120V - Triac/ELV
E4LK87ICA-EM1	120V - Triac/ELV Emergency Battery Back-up (90 min)
E4LK88ICAD	120/277V - 0-10V/ Triac/ELV
E4LK88ICAD-EM1	120/277V - 0-10V/ Triac/ELV Emergency Battery Back-up (90 minute)



4" ICA Housing - 5 1/2" Height
Remodel

CAT NO.	SPECIFICATIONS
E4LK87RICA	120V - Triac/ELV
E4LK88RICAD	120/277V - 0-10V/Triac/ELV