

TAPER

1563MBS

STEP 12V HORIZONTAL

Seamlessly blending into architectural elements inside or outside the home, the Taper series beautifully illuminates stairs, walkways, or patio spaces to enhance any lighting experience. Part of the Sparta Series, Taper Step Lights with Matte Black Stainless Steel construction, offering superior strength in harsh environments. A recessed mount and integrated 12v LEDs can be easily integrated into masonry or wooden structures, providing a practical, low-voltage solution for any setting.

DETAILS	
FINISH:	Matte Black Stainless
MATERIAL:	Stainless Steel
GLASS:	Etched Lens
DIMMABLE:	YES - WITH MLV ON TRANSFORMER PRIMARY

DIMENSIONS	
WIDTH:	5"
HEIGHT:	3.5"
DEPTH:	1
WEIGHT:	1.2lb

LIGHT SOURCE	
LIGHT SOURCE:	Integrated LED
LED NAME:	ETP15
WATTAGE:	1.90w LED *Included
VOLTAGE:	12v
VOLT AMPS:	2.3
LUMENS:	160
CRI:	90
INCANDESCENT EQUIVALENCY:	1 x 15w
DIMMABLE:	YES - WITH MLV ON TRANSFORMER PRIMARY
TRANSFORMER REQUIRED:	Yes

MOUNTING	
LEAD WIRE:	1 X 60"

SHIPPING	
CARTON LENGTH:	6.3
CARTON WIDTH:	5.5
CARTON HEIGHT:	3
CARTON WEIGHT:	1.4

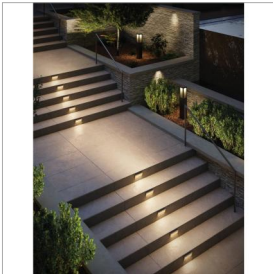
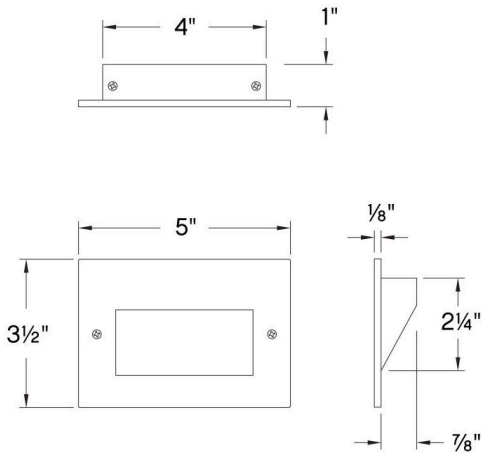

PRODUCT DETAILS:

- Stainless steel provides superior strength and performance
- Suitable for use in wet (outdoor direct rain) locations as defined by NEC and CEC. Meets United States UL Underwriters Laboratories & CSA Canadian Standards Association Product Safety Standards
- A wiring kit is supplied
- ADA compliant
- For more information on how to control your landscape lighting via the Hinkley Home Automation App, [click here](#).
- Recessed mount.
- Rated for both indoor and outdoor use
- Easy and efficient installation: fewer fixtures illuminate a more extensive area, offering a diverse range of mounting opportunities.

HINKLEY

HINKLEY
33000 Pin Oak Parkway
Avon Lake, OH 44012

PHONE: (440) 653-5500
Toll Free: 1 (800) 446-5539

hinkley.com