

# 2" Koto™ Architectural Maximum Adjustability High Lumen IC Airtight Housing



Koto™ Architectural High Lumen Housing: 120V (Triac/ELV) or 120/277V (0-10V/Triac/ELV) with optional Emergency Battery Backup. Must be used with Koto™ Architectural LED Light Engines (ELK21 Series Only).

## Features

- IC Airtight for direct contact with insulation.
- Easy-to-Remove driver.
- Optional 90 minutes, 120/277 VAC, 60Hz, Emergency Backup.
- Flicker-Free Dimming.
- USA designed and assembled.
- Limited 5 year warranty.
- For use with ELCO Koto™ Architectural LED Light Engines (ELK21 Series Only).

## Specifications

<b>Wattage</b>	15.7W - 18.9W
<b>Lumens</b>	1350 lm - 1500 lm
<b>Voltage</b>	120/277V or 120V
<b>Dimmable</b>	Triac/ELV, 0-10V/Triac/ELV
<b>Lamp Type</b>	LED
<b>Power Factor</b>	≥0.95
<b>Damp Location</b>	Listed

## Dimensions

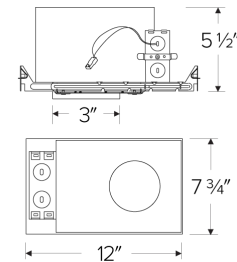

## Technical Details

**Construction:** Double Wall IC Rated for direct contact with insulation. For use in IC and Non-IC conditions. Up to 1500 lumens. Housing accommodates up to 5/8" ceiling thickness. Airtight housing with gasket to restrict airflow in accordance with ASTM E-283 air-tight requirements.

**Installation:** Designed for ceiling plenums where 2x6 joists or taller are used. High strength hanger bars can easily be nailed to joists. Suitable for T-grid and drop ceiling applications. See installation sheet for detailed information. Emergency Battery Back-up Option requires access from above. For use with ELCO Koto™ Architectural LED Light Engines (ELK21 Series Only)

**Junction Box:** Positioned to accommodate straight conduit runs. Two 3/4" knockouts, Seven 1/2" trade size conduit knockouts, One 3/8" knockout. Four Pry-out knockout slots for easy romex installation.

**Hanger Bars:** Pre Installed hanger bars with True Nail easy installation in regular lumber, engineered lumber, and Laminated Beams. Integral T-bar slots for easy installation in T-Bars. Spans up 24" and can be repositioned 90°. Score lines allow for tool-free hanger bar size reduction. Integral leveling flange allows for single-person installation while easily aligning the housings with the joists.

**Electrical:** Driver is rated for 120V and 277V input (120/277V). High Efficiency driver with a power factor > 0.95.

**Emergency Battery Pack:** Optional 90 minute battery pack available with test indicator switch. Note that double wall housings require Access From Above Ceiling for Battery Maintenance.

**Dimmability:** 3-in-1 dimming: Triac, ELV and 0-10V dimming in one driver. 0-10V dimming down to 5% with a compatible dimmer. Can be specified with Lutron drivers for 0.1% and 1% dimming. For a full list of dimmers refer to the Dimmer Compatibility List.

**Listings:** UL Listed for Damp Location and for Wet Location with select trims. UL Listed for Direct Contact with Insulation and Combustible Material. UL Listed for Feed Through.

## Product Numbers

Item	Description	Lamp type	Lumens	Watts	Voltage	Dimming
<b>E2LK41ICA</b>	Maximum Adjustability Housing	LED	1350 lm	15.7W	120V	Triac/ELV
<b>E2LK42ICAD</b>	Maximum Adjustability Housing	LED	1350 lm	15.7W	120/277V	0-10V/Triac/ELV
<b>E2LK94ICA</b>	High Lumen Maximum Adjustability Housing	LED	1500 lm	18.9W	120V	Triac/ELV
<b>E2LK95ICAD</b>	High Lumen Maximum Adjustability Housing	LED	1500 lm	18.9W	120/277V	0-10V/Triac/ELV

# Compatible Products

For use with Dedicated 2" Koto Architectural ICA LED Housings

## Koto™ Architectural LED Light Engine

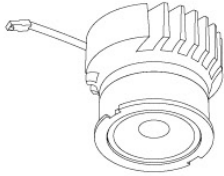

**Koto™ LED Light Engine**  
ELK19 - ELK21

PRODUCT NUMBER BUILDER			
Koto™ LED Light Engine	Lumens	Color Temperature	Beam Angle
ELK			
19	750 - 850 lm	27D 2700K	(blank) 38° lens (Standard)
21	1100 - 1500 lm	30D 3000K	-S 18° lens
		35D 3500K	-N 25° lens
		40D 4000K	-W 60° lens
		SD Sunset Dimming (ELK19 Only)	-FC 18° - 50° Adjustable (ELK21 Only)

### ACCESSORIES



#### Lens

- EP731C** 18° Lens
- EP732C** 25° Lens
- EP733C** 38° Lens
- EP734C** 60° Lens

\*EP732C, EP733C, EP734C Included



#### Snoot

- L50W** White
- L50B** Black



#### Secondary Optics

- L45** Hex Louver
- L46** Linear Lens
- L47** Spread Louver
- L49** Frosted Lens
- L51** Color Shifter

## 2" Pex™ Twist-On Trims



**Round Deep Reflector**

**ELK2818**  
Finishes:  
(W, B, H, BB, BZ)



**Round Adjustable Reflector**

**ELK2829**  
Finishes:  
(W, B, H, BB, BZ)



**Round Adjustable Pinhole**

**ELK2827**  
Finishes:  
(W, B, BB, BZ)

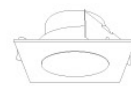

**Square Deep Reflector**

**ELK2518**  
Finishes:  
(W, B, BB)

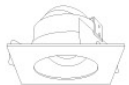

**Square Adjustable Reflector**

**ELK2529**  
Finishes:  
(W, B, BB)



**Square Reflector**

**ELK2541**  
Finishes:  
(W, B, BB)



**Square Adjustable Pinhole**

**ELK2527**  
Finishes:  
(W, B, BB)



**Round Gimbal**

**ELK2888**  
Finishes:  
(W, B, BB)

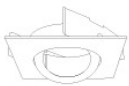

**Square Gimbal**

**ELK2588**  
Finishes:  
(W, BZ)